

Operation Instructions

Make your choice...

M-204E Infrared sensor



1 Safety Instructions



Thank you very much for your purchasing, please read this manual carefully before use.

2 Product Overview

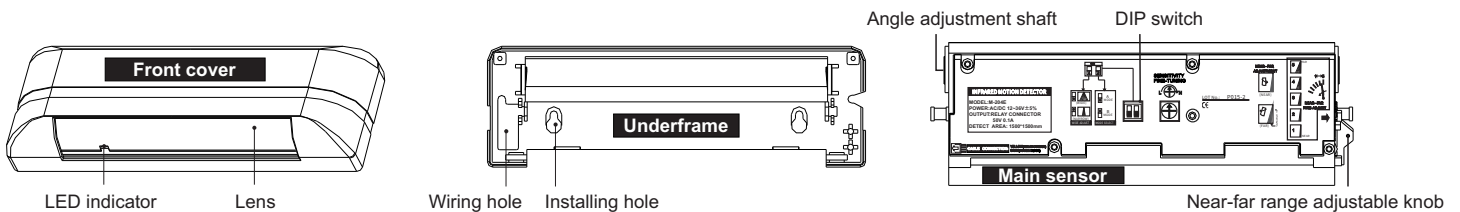

3 Wiring

This sensor with integrated plug and equipped with connection wire, as follows:



Yellow wire: Relay connect output(COM, NO)

Grey wire: Power input(AC/DC 12-36V)

4 Installation Precautions

1, Installation height $\leq 3\text{m}$, otherwise sensor sensitivity will be low.

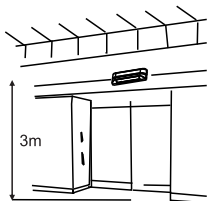

2, Please don't place any shaken objects in the detecting area, like curtain, potted plants etc, avoid error movement.

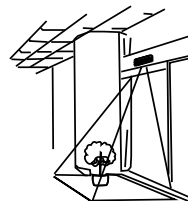

3, Please don't put the sensor in the place where is invaded by steam or fog, avoid error movement.

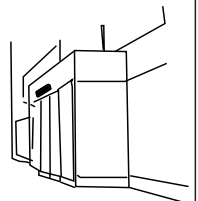

4, Though this sensors have anti-interference function. In order to use it better, please make sure the installation distance, and when installed too close, please set A mode or B mode respectively.

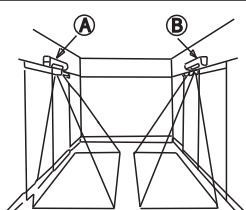

5, Please don't install the sensor on the place with the direct sunlight, avoid error movement.

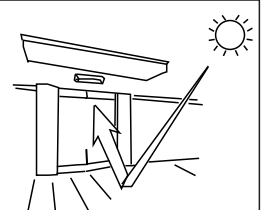

5 Installation Method

1, Drill a wiring hole of diameter of 3.5mm and a hole of 10mm respectively in the proper place.

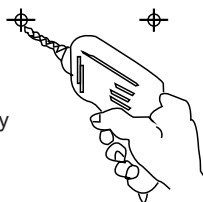

2, Fix the underframe on the wall with two screws.

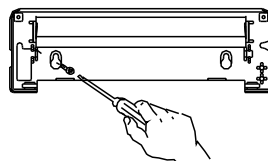

3, Fix the main sensor in the underframe.

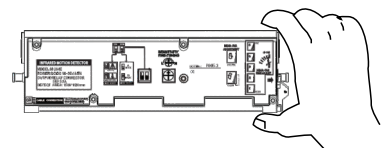

4, Connect the sensor and automatic door controller by cable plug, grey wire is power supply wire, yellow wire is contact signal wire, no polarized.

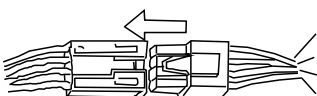

5, Put the cable plug into the hidden place.

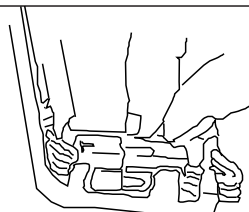

6, Close the outer cover after adjusted all parameters setting.

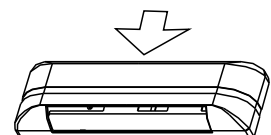

6 Adjustment and Setting

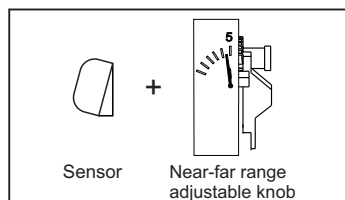

When adjusting the main sensor to the most tilt angle through the angle adjustment shaft, and set the side range adjustable knob to "5" position, then it is the farthest detection distance.

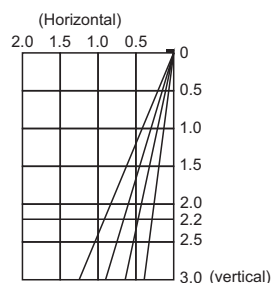

Far detection distance

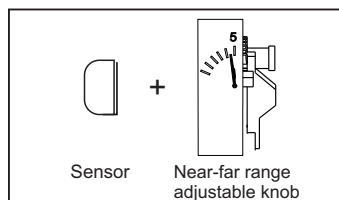

When adjusting the main sensor to the most vertical angle through the angle adjustment shaft, and set the side range adjustable knob to "1" position, then it is the closest detection distance.

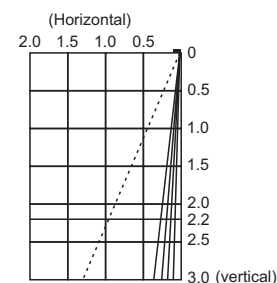

Near detection distance

Far-near detection range chart(Unit: meter)

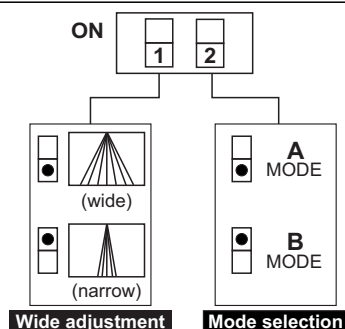

1, DIP switch NO.1, used for wide adjustment of detection range.

- ☐ switch into low position: the maximum detection width, about 1500mm(Factory default value)
- ☐ switch into high position: the minimum detection width, about 600mm

2, DIP switch NO.2, used to select the working frequency mode.

In order to avoid interference between the two sensors installed nearby, please confirm to select different frequency mode, A or B mode. (Factory default is A mode)



Sensitivity adjustable knob: H=HIGH SENSIBILITY ; L=LOW SENSIBILITY

7 Troubleshooting

Symptom	Cause	Methods
No action	Connection cable loose/not Connected	Please ensure the cable has been connected
	Power or voltage not stable	Please use the standard power(AC/DC 12~36V)
Sometimes doesn't work, low sensitivity	1. The induction window is eroded by dust or water droplets; 2. Lack of sensitivity	1. Clean with a soft cloth; 2. Adjust sensitivity knob clockwise
	Detection range is not proper	Adjust oblique of the detector body
With no human body through it, the sensor action	Moving objects is placed within the detection range	Adjust detection range or remove wobbling objects
	Moving people within the detection range	Adjust the dip switch, and adjust the tilt of the sensor
	Action with high sensitivity	Adjust sensitivity knob counterclockwise

8 Technical Parameters

Ray type: Reflect infrared	Consumption capacity: <2.5VA
Quantity of ray: 8 emit rays and 8 receive rays	Output connect: Passive normally open contact, DC 50V, 0.1A
Function: detect the moving object, motion	Output holding time: 2 seconds
Max. installation height: 3000mm	LED indicator: detect state in RED, standby state in GREEN
Detection range adjustable: main sensor angle 0°-10°, tilt angle used for far-near detection adjustment, dip switch for width setting	Working temperature: -20°C~60°C
Power supply: AC/DC 12~36(±15%)	Total Weight: about 400G
	Color: silver
	Overall Dimension: 220mm(L)×74mm(W)×36mm(H)

9 Packing List

Name	Quantity	Name	Quantity
sensor	1	screws	2
2.5 meter cable	1	Instructions	1